

AP BZ-UP/DOWN Belt Drive Positioning System



AP60BZ

AP80BZ

AP110BZ

Up/Down Belt Drive Position System

Type : AP BZ

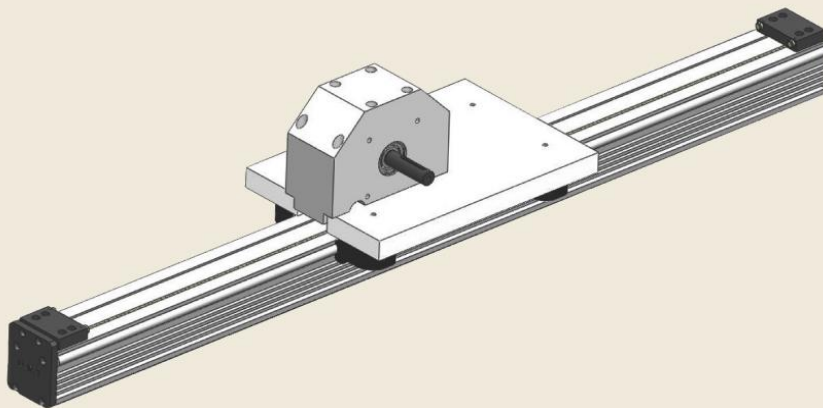

Distinction

- Application : Up-down axis
- Principle of operation : Belt drive unit
- Material : Beam & Carriage plate – AL6061 profile
Guide shaft – SUJ2
Bearing Roller – Hardened steel
- Speed : Bearing roller based U slide system allows speeds in excess of 3~6 m/s
- Durable : Rugged construction – All steel hardened slideway—unique wiping action excludes debris
- Installation : in various position
- 적용 : Gantry의 Up-down용
- 구동원리 : 벨트 구동 형식
- 재질 : Beam & Carriage plate – AL6061 profile
Guide shaft – SUJ2
- 속도 : 베어링 롤러의 U형 안내방식은 3~6m/s의 속도를 충분히 견딘다.
- 내구성 : 슬라이드부는 열처리 강을 사용하며 와이퍼 장치는 불순물을 제거하여 수명을 향상 시킨다.
- 설치 : 다양한 위치 설치 가능



AP BZ-UP/DOWN Belt Drive Positioning System

AP60BZ

AP80BZ

AP110BZ

Belt Drive System AP60BZ

Beam Size	Dynamic Force(N)	Max. Speed	Max. Length	Shaft Diameter	Roller Type	Belt Type	Pulley 잇수(z)	Cycle Distance	Repeat-ability
AP60	1,000	3m/s	4,000	φ 10	G10B	S8M-25	18	144mm/rev	± 0.2mm

Dimension For AP60BZ

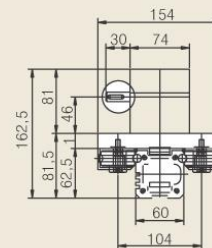
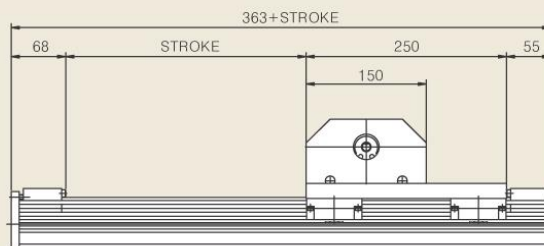
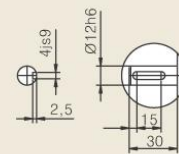
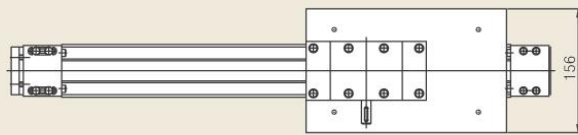
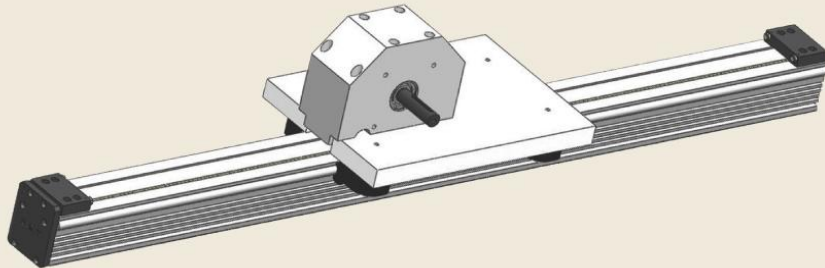

AP BZ-UP/DOWN Belt Drive Positioning System



AP60BZ

AP80BZ

AP110BZ

Belt Drive System AP80BZ

Beam Size	Dynamic Force(N)	Max. Speed	Max. Length	Shaft Diameter	Roller Type	Belt Type	Pulley 잇수(z)	Cycle Distance	Repeat-ability
AP80	1,700	4m/s	5,000	φ 16	G16B	S8M-30	24	192mm/rev	± 0.2mm

Dimension For AP80BZ

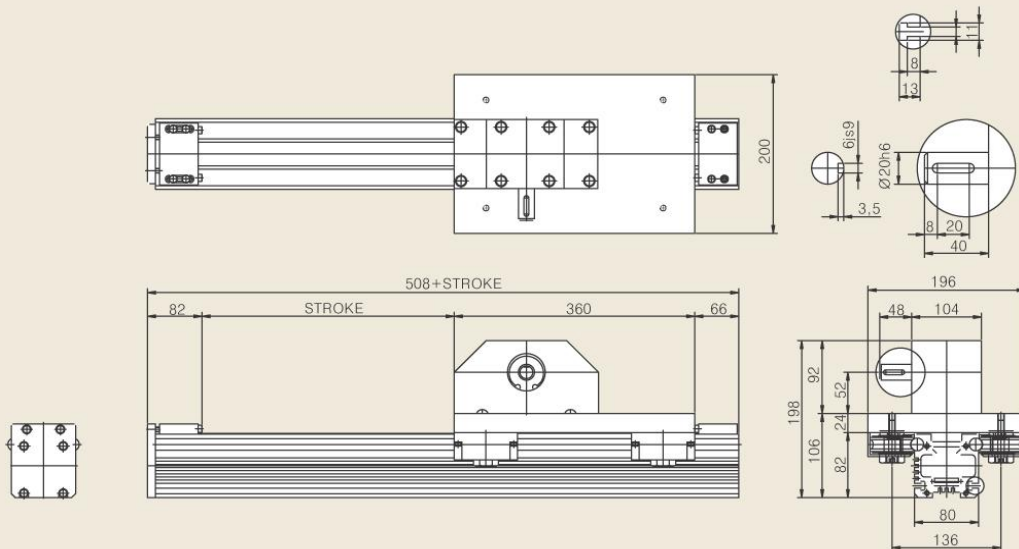
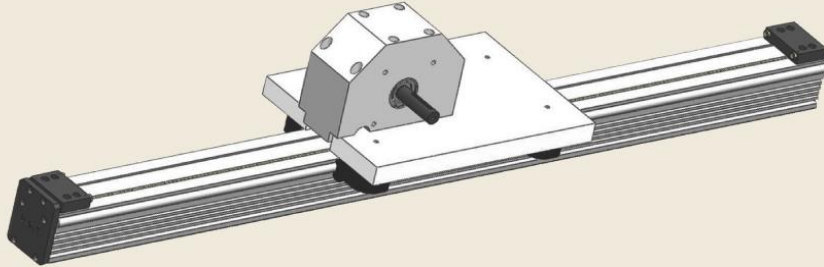



AP BZ-UP/DOWN Belt Drive Positioning System

AP60BZ

AP80BZ

AP110BZ

Belt Drive System AP110BZ

Beam Size	Dynamic Force(N)	Max. Speed	Max. Length	Shaft Diameter	Roller Type	Belt Type	Pulley 잇수(z)	Cycle Distance	Repeat-ability
AP110	2,200	6m/s	5,000	φ 20	G20B	S8M-50	32	256mm/rev	± 0.2mm

Dimension For AP110BZ

